

142-101, AND 143-134, COMMERCIAL LOTS
 7-15 AND 20-27, AND TRACT C OF OSHARA
 VILLAGE, PHASE I, SANTA FE, NEW MEXICO
 TOWNSHIP 16 NORTH, RANGE 9 EAST, SECTION 16

OFFICE OF THE COUNTY CLERK, AND RECORDED IN BOOK 402
 PAGES 44-50 AS INSTRUMENT NO. 1423082

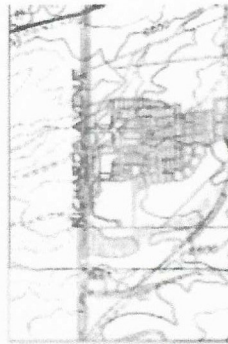

VICINITY

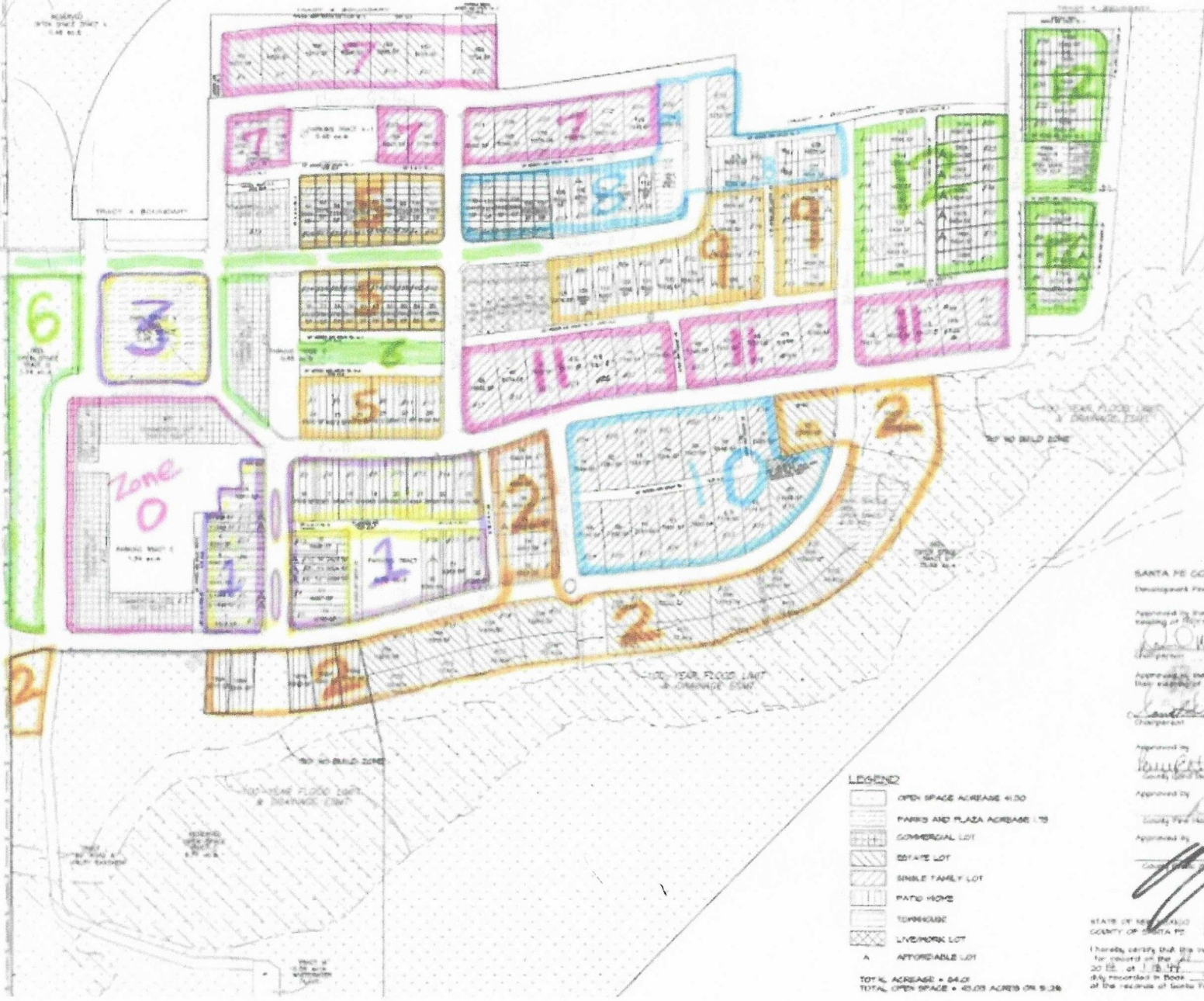

PURPOSE STATEMENT:
 TO CHANGE ZONING OF 16 LOTS FROM
 LULU HOME TO FOREBROKE
 TO CHANGE ZONING OF 11 LOTS FROM
 LULU HOME TO
 TO CHANGE ZONING OF 11 COMMERCIAL
 LOTS AND 20-27 TO A PAVED HOME
 TO ALLOW 5 PAVED HOMES TO BE DEV

ATTORNEY:
 ONLY ALL PERSONS BY THESE PRESENTS
 ORDER HAVE CAUSED THE MASTER PLAN
 PREPARED. ALL THE APPEARERS ON THE
 MASTER PLAN AND IN ACCORDANCE WITH
 UNDEVELOPED OWNERS, THE DEVELOPER
 PLANNERS AND PLATTING JURISDICTION

Owner of Lots 16-26 and 22-10
 Monument, Inc.
 Michael D. Loflin, Executive Dir

The foregoing was sworn, acknowledged
 before me by Michael D. Loflin, Executive
 Director, on this 20th day of
 February, 2013, at Santa Fe, New Mexico.
 My Commission Expires on 2/13/16.

SANTA FE COUNTY APPROVALS
 Development Plans # 13-5200

Approved by the Board of County Commissioners of Santa Fe
 County on February 12, 2013.
 [Signature] 1-15-2013 Date

Approved by the Santa Fe County Planning Commission of
 Santa Fe County on February 12, 2013.
 [Signature] 1/15/13 Date

Approved by
 [Signature] 1/15/13 Date

Approved by
 [Signature] 1/15/13 Date

Approved by
 [Signature] 1/16/14 Date

Owner of Lots 140-154, Corner
 and Tract C
 Century Bank
 Don K. Faggott, President and
 The foregoing was sworn, acknowledged
 before me by Don K. Faggott, President
 on this 20th day of
 February, 2013, at Santa Fe, New Mexico.
 My Commission Expires on 2/13/16.

- LEGEND**
- [Hatched Box] OPEN SPACE ACREAGE 41.00
 - [Hatched Box] PARKS AND PLAZA ACREAGE 1.70
 - [Hatched Box] COMMERCIAL LOT
 - [Hatched Box] ESTATE LOT
 - [Hatched Box] SINGLE FAMILY LOT
 - [Hatched Box] PAVED HOME
 - [Hatched Box] FOREBROKE
 - [Hatched Box] LIVABLE LOT
 - [Hatched Box] AFFORDABLE LOT
- TOTAL ACREAGE = 64.01
 TOTAL OPEN SPACE = 42.03 ACRES OR 65.36

STATE OF NEW MEXICO No. 1423082
 COUNTY OF SANTA FE No. 1423082

I hereby certify that the instrument was filed
 for record on the 20th day of February, A.D.
 2013, at 1:15 PM, and was
 duly recorded in Book 402 Page 44-50
 of the records of Santa Fe County.



DESIGN 6

MASTER PLAN AS
 PORTION OF OSHARA